

Block No 38

More's and Newhouse's Addition to the City of Corvallis in

Benton County, Oregon.
East

Received for Record and Recorded
Dec. 31st 1887.
B. W. Mason

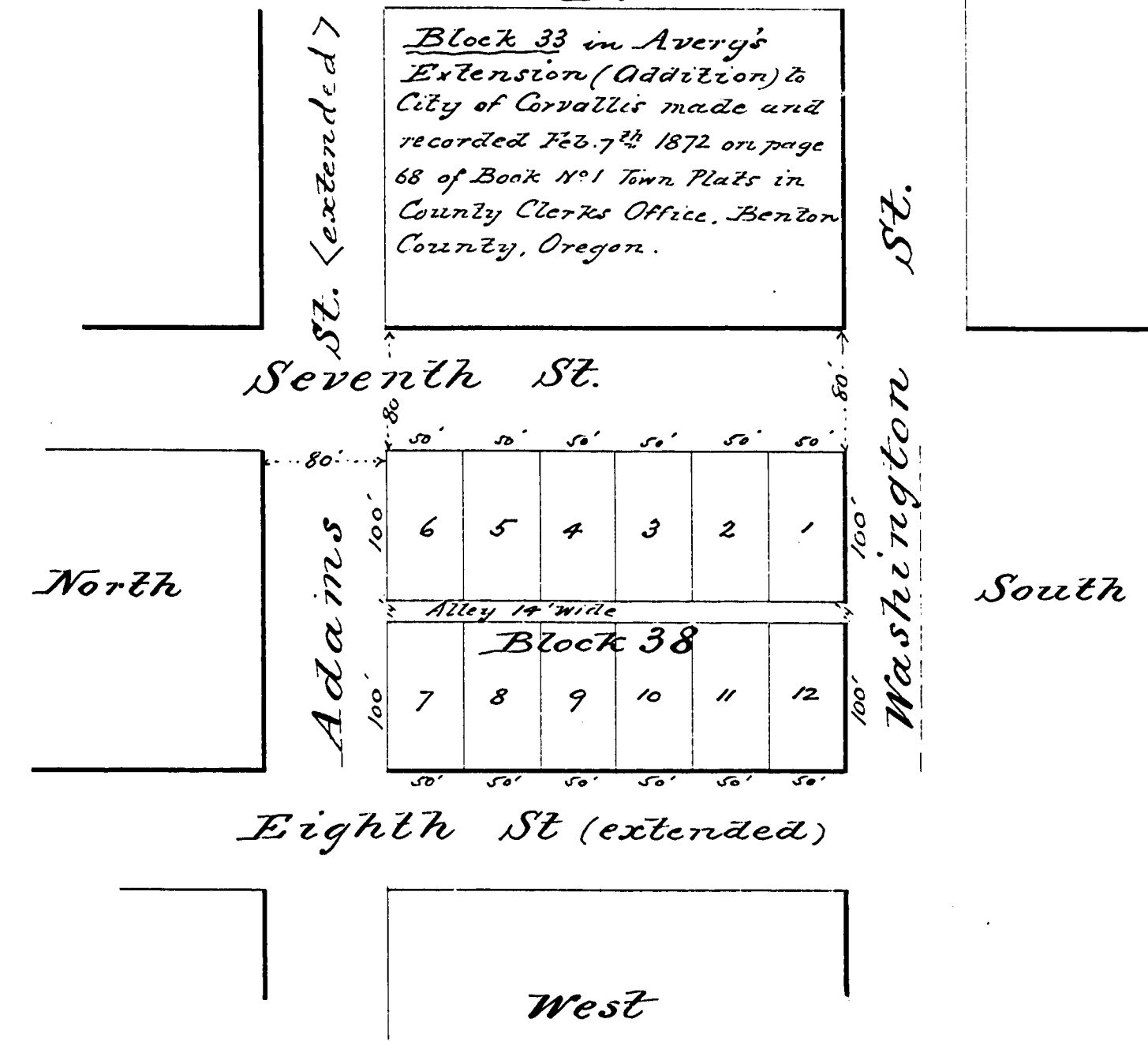

Know all men by these presents that we R. W. Moore and Niel M. Newhouse being the Owners in fee simple of that certain piece or parcel of land situate in the corporate limits of the City of Corvallis in Benton County, Oregon, and conveyed by Joseph Avery and wife to Peter Blake by deed bearing date March 12th 1872 and which is recorded on page 587 of "Book I" of records of deeds of said County, as Block No 38 in the City of Corvallis. R. W. Moore owning the northerly half of said block and Niel M. Newhouse the southerly half thereof the division line running parallel with the streets of said City and nearly East and West: and said piece or parcel of land being 300 ft. wide and 214 ft. deep and lying across Seventh Street in said City immediately opposite and West of Block 33 in Avery's Extension (Addition) to the said City of Corvallis, made and recorded February 7th 1872 on page 68 of Book No 1 of Town Plots in the Office of the County Clerk of Benton County, Oregon: hereby lay out said piece or parcel of land as an Addition to said City of Corvallis to be known as "Block No 38" Moore and Newhouse's Addition to the City of Corvallis" and we hereby divide the same into twelve lots 50 feet by 100 feet with a fourteen foot Alley as shown on the Plat of said "Block No 38" hereto attached, and made and filed herewith, and we hereby dedicate said Alley to the use of the Public. Witness our hands and seals this 30th day of Dec. A.D. 1887

State of Oregon }
County of Benton } s.p. This certifies that on this 30th day of December 1887 personally appeared before me, the within named R. W. Moore and Niel M. Newhouse who are known to me to be the identical persons who executed the foregoing instrument and made the annexed plat, and each for himself acknowledged to me that he executed the same and made said plat of Block No 38 for the purpose of laying the same out as and Addition to said City of Corvallis and for the uses and purposes therein stated. Witness my hand and Notarial seal the day and year last above written.

I certify that I have compared the foregoing plat and dedication or writing, with the Original record of the same, re-copied by me from pages 54 of Book No. 2 of records of Towns, Benton County records, in compliance with an act of the Legislative Assembly of the State of Oregon, filed Feb. 18, 1891 (see pages 61 and 62, Session Laws of Oregon for 1891,) that it is a true and correct transcript therefrom, and of the whole thereof and that I am the legal custodian of the same, this 1st day of July 1892.

B. W. Mason
County Clerk
By J. W. Mason
Deputy

In presence of
J. R. Brynson }
H. B. Lowman }

R. W. Moore (seal)
Niel M. Newhouse (seal)



J. R. Brynson
Notary Public