

# Simpson's Chapel Cemetery

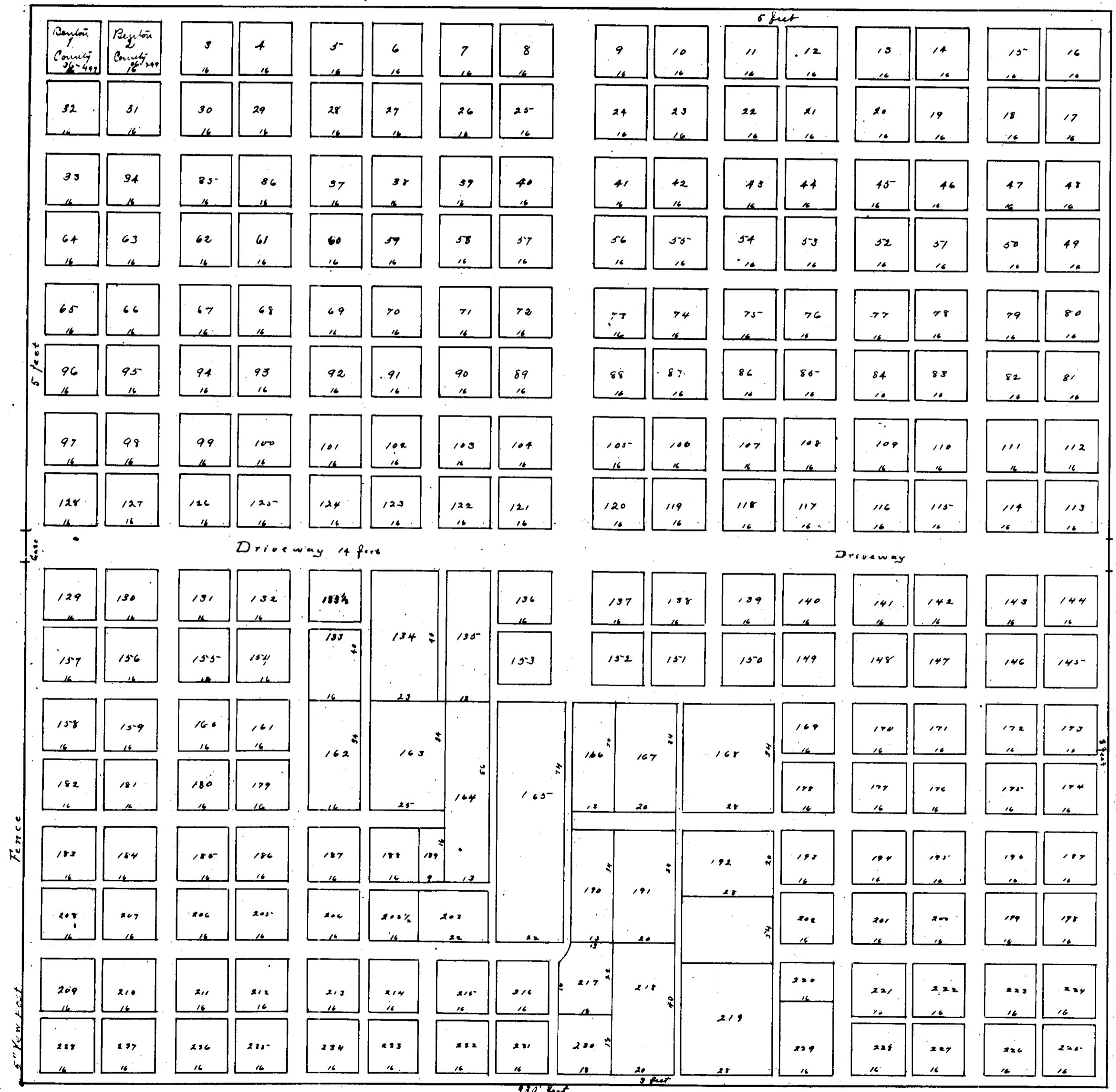

Know all Men by these Presents, That we owners by virtue of their position as representatives of the said Church, of Simpson Chapel Cemetery in Benton County, Oregon, hereby lay out the same as a Cemetery consisting of 238 Lots with driveway, walks and alleys as shown on the said annexed plat of the same.

Witness our hands and seals this --- day of January 1896  
 Done in presence of  
 S. L. Lee  
 Lewis Halcomb  
 J. T. Carpenter  
 S. R. Hawley  
 Robert Kyle  
 L. H. Hawley  
 S. A. Tharp  
 A. W. Hawley  
 J. W. Howard  
 J. B. Goodman

State of Oregon }  
 County of Benton }  
 This certifies that on this the 13<sup>th</sup> day of January 1896, before me, personally came S. R. Hawley, Robert Kyle, L. H. Hawley, S. A. Tharp, A. W. Hawley, J. W. Howard, J. B. Goodman whose names are subscribed to the foregoing dedication and they each duly acknowledged to me that they executed the same for the uses and purposes therein expressed, as Trustees of Simpson's Chapel of the M. E. Church.  
 In Testimony Whereof I have hereunto set my hand and seal the day and year above written.  
 J. T. Carpenter  
 Justice of the Peace

State of Oregon }  
 County of Benton }  
 I, George H. Waggoner being duly sworn depose and say that I am the Surveyor who surveyed the "Simpson's Chapel Cemetery" mentioned on the foregoing Plat and marked with proper stakes the Lots, streets and alleys as designated thereon; That I correctly surveyed the same; That the initial or starting point of such survey the same being a New post about 5 inches in diameter and about 4 feet high firmly driven in the ground. Said stake is situated in the North West corner of a certain tract of Land deeded to the Trustees of the M. E. Church for a Cemetery which said tract of land is situated on the Original Don. Ld. Ch. of Jesse Belknap being Claim No. 41 T. P. 14 S. R. & W.

Geo. H. Waggoner  
 Surveyor  
 Subscribed and sworn to before me this 23<sup>rd</sup> day of January 1896  
 J. M. Hunter, County Clerk  
 By A. Carlisle

Received for Record Jan 29<sup>th</sup> 1896  
 at 3:25 P.M. and Recorded  
 Fergil C. Hutton  
 County Recorder

I hereby certify this copy to be a true, full and correct copy of the original now on record in my office.  
 DANIEL G. BURK  
 Director of Records and Elections  
 By *[Signature]*  
 Deputy

18.24 Chs. N.  
 366 W. E.  
 SW. corner of  
 Jesse Belknap C. H. W.  
 T. 14 S. R. 14 W. M. 1/4