

Know all Men by These Presents:—
 That I, Louisa Irwin, being the owner in fee simple of the following described tract of land, to-wit: A tract of land within the corporate limits of the City of Corvallis, Benton County, State of Oregon, as now incorporated, and being bounded on the East side by Seventh Street in said City; on the North by Jefferson Street in said City; on the West by Eighth Street in said City; and on the South by Adams Street in said City; and being the same land conveyed to me by Robert McLogan and wife by Deed dated October 31, 1866, and recorded in Book J. at page 71 therein, records of deeds for Benton County, Oregon, do hereby plat and lay off the same, as an Addition to the City of Corvallis, Oregon, to be known and designated as:

Block No. 39, Louisa Irwin's Addition to the City of Corvallis, Benton County, State of Oregon, which said tract is laid off and platted as one Block, subdivided into twelve lots, numbered from one to twelve inclusive, and with an alley fourteen feet wide running North and South through center of said Block, all of the size and dimensions, as shown and designated on the annexed Plat and Affidavit of Surveyor of and concerning said Addition.

And I hereby dedicate said alley to the use of the public.
 In Witness Whereof I have hereunto set my hand and seal this 16th day of February, A. D., 1905.
 Executed in Presence of:
 Louisa Irwin
 E. E. Wilson

State of Oregon, }
 County of Benton, }
 This certifies that on this 16th day of February, 1905, before me, the undersigned, personally appeared the within named Louisa Irwin, who is personally known to me to be the identical individual described in and who executed the within instrument, and acknowledged to me that she executed the same freely and voluntarily for the use and purposes therein mentioned.

In Testimony Whereof I have hereunto set my hand and Notarial seal the day and year last above written.
 E. E. Wilson
 Notary Public for Oregon.

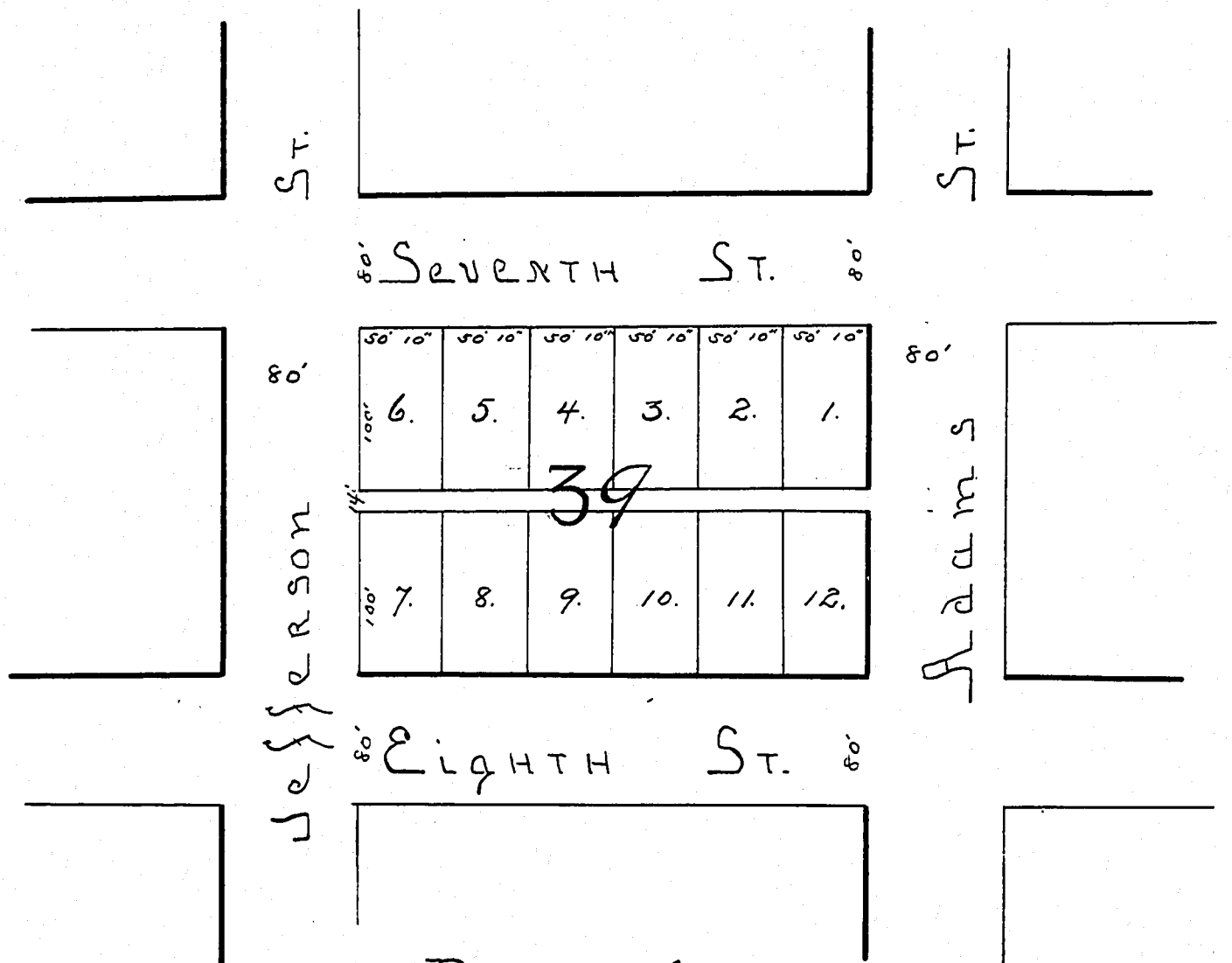

Plat of
Block 39, Louisa Irwin's
Addition to the
City of Corvallis, Benton
County, State of Oregon.

State of Oregon, }
 County of Benton, }
 J. T. A. Jones, being first duly sworn, says: That I am the Surveyor who surveyed the land represented on the annexed Plat, and laid off as an Addition to the City of Corvallis, to be known as "Block No. 39, Louisa Irwin's Addition to the City of Corvallis, Benton County, State of Oregon"; That I have surveyed and marked with proper monuments the land as represented;

That the initial point of such survey is the Northeast corner of said Block No. 39 as shown on the annexed plat, which said initial point is described as follows, to-wit: Beginning at a stone set for the Southeast corner of the donation land claim of Joseph P. Fralby and wife, Notification No. 937, Claim No. 62, in Township 36N, Range 10W, and now thence North 88 degrees 30 minutes East 1527.75 feet to the Northeast corner of the West half of the donation land claim of Joseph C. Avery and wife; thence South on the division line between the East and West halves of said Avery claim 2.08 chains to North boundary line of Jefferson Street in said City of Corvallis; thence South 70 degrees and 30 minutes E. along the North boundary line of said Jefferson Street in the City of Corvallis, 787.7 feet to the Southeast corner of Block 14 in the County Addition to the town of Mansville (formerly) (but now changed to the City of Corvallis); thence Southerly at right angles to said North line of Jefferson Street 81 feet to said initial point, which said initial point I have marked by driving a piece of gas pipe 1/4 inches in diameter, and 2 feet long, three feet into the ground and plugging on top of said piece of gas pipe a stone, 6 inches by 6 inches by 6 inches in dimensions.
 Thos. A. Jones.

Subscribed and sworn to before me this 16th day of February, 1905.
 E. E. Wilson
 Notary Public for Oregon.

Received for record and recorded,
 Feb. 23rd 1905. At 5⁴⁵ A. M.
 J. T. Vincent,
 Co. Recorder.

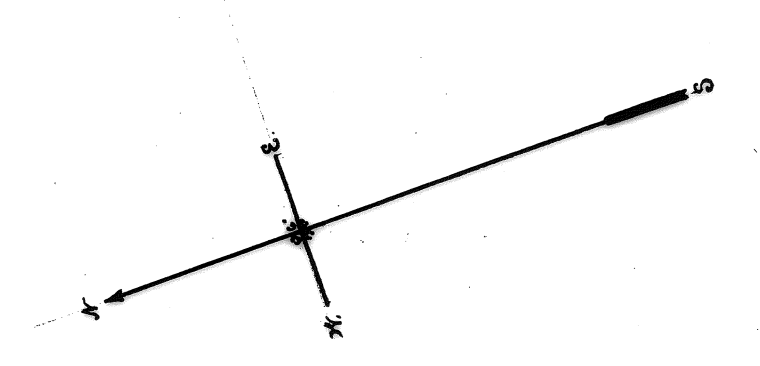

Know all men by These Presents:-
 That I, Louisa Irwin, being the owner in fee simple of the following described tract of land, to-wit: A tract of land within the corporate limits of the City of Corvallis, Benton County, State of Oregon, as now incorporated, and being bounded on the East side by Seventh Street in said City; on the North by Jefferson Street in said City; on the West by Eighth Street in said City; and on the South by Adams Street in said City, and being the same land conveyed to me by Robert M. Logan and wife by Dec. dated October 31, 1866, and recorded in Book J. at page 71 therein, records of deeds for Benton County, Oregon. Do hereby plat and lay off the same as an Addition to the City of Corvallis, Oregon, to be known and designated as:

Block No. 39, Louisa Irwin's Addition to the City of Corvallis, Benton County, State of Oregon, which said tract is laid off and platted as one Block, subdivided into twelve lots, numbered from one to twelve inclusive, and with an alley fourteen feet wide running North and South through center of said Block, all of the size and dimensions as shown and designated on the annexed Plat and Affidavit of Surveyor of and concerning said Addition.

And I hereby dedicate said alley to the use of the public.
 In Witness Whereof I have hereunto set my hand and seal this 16th day of February, A. D., 1905.
 Executed in Presence of:
 Louisa Irwin
 E. C. Wilson

State of Oregon, }
 County of Benton, }
 This certifies that on this 16th day of February, 1905, before me, the undersigned, personally appeared the within named Louisa Irwin, who is personally known to me to be the identical individual described in and who executed the within instrument, and acknowledged to me that she executed the same freely and voluntarily for the use and purpose therein mentioned.

In Testimony Whereof I have hereunto set my hand and official seal the day and year last above written.
 E. C. Wilson,
 Notary Public for Oregon.

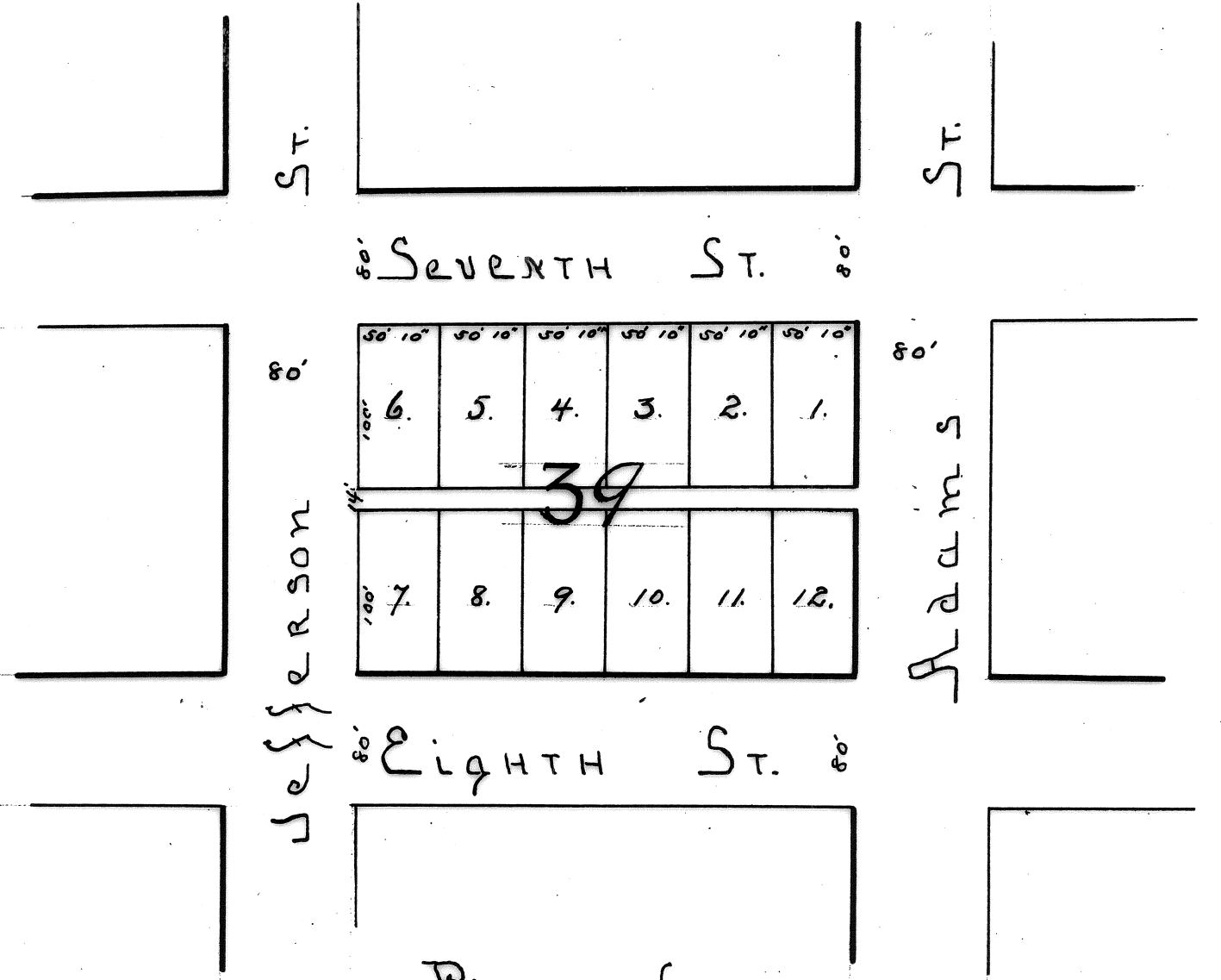

PLAT of
Block 39, Louisa Irwin's
Addition to the
City of Corvallis, Benton
County, State of Oregon.

State of Oregon, }
 County of Benton, }
 I, J. A. Jones, being first duly sworn, say: That I am the Surveyor who surveyed the land represented on the annexed Plat, and laid off as an Addition to the City of Corvallis, to be known as "Block No. 39, Louisa Irwin's Addition to the City of Corvallis, Benton County, State of Oregon"; That I have surveyed and marked with proper monuments the land as represented;

That the initial point of such survey is the north-east corner of said Block No. 39 as shown on the annexed plat, which said initial point is described as follows, to-wit: Beginning at a stone set for the southeast corner of the donation land claim of Joseph P. Fidelity and wife, Notification No. 987, Claim No. 62, in Township 36N, Range 7W, and run thence North 88 degrees 30 minutes East 1527.75 feet to the northeast corner of the West half of the donation land claim of Joseph C. Avery and wife; thence South on the division line between the East and West halves of said Avery claim, 2.08 chains to North boundary line of Jefferson Street in said City of Corvallis; thence South 70 degrees and 30 minutes E. along the North boundary line of said Jefferson Street in the City of Corvallis, 787.7 feet to the south-east corner of Block 19 in the County Addition to the town of Mansfield (formerly) (but now changed to the City of Corvallis); thence South at right angles to said North line of Jefferson Street, eighty feet to said initial point which said initial point I have marked by driving a piece of gas pipe 1/4 inches in diameter, and 2 feet long, three feet into the ground and planting on top of said piece of gas pipe a stone 6 inches by 6 inches by 6 inches in dimension.
 J. A. Jones

Subscribed and sworn to before me this 16th day of February, 1905.
 E. C. Wilson
 Notary Public for Oregon.

Received for record and recorded,
 Feb. 23rd 1905. At 8⁴⁵ A. M.
 J. P. Vincent,
 Co. Recorder.

I hereby certify this copy to be a true and correct copy of the original filed on record in my office.
 DANIEL G. BURK
 Director of Records
 and Elections
 by D. G. Burk
 Deputy