

Millers Second Addition.

Scale 1 in = 50 ft.
All points are marked with a gas pipe.

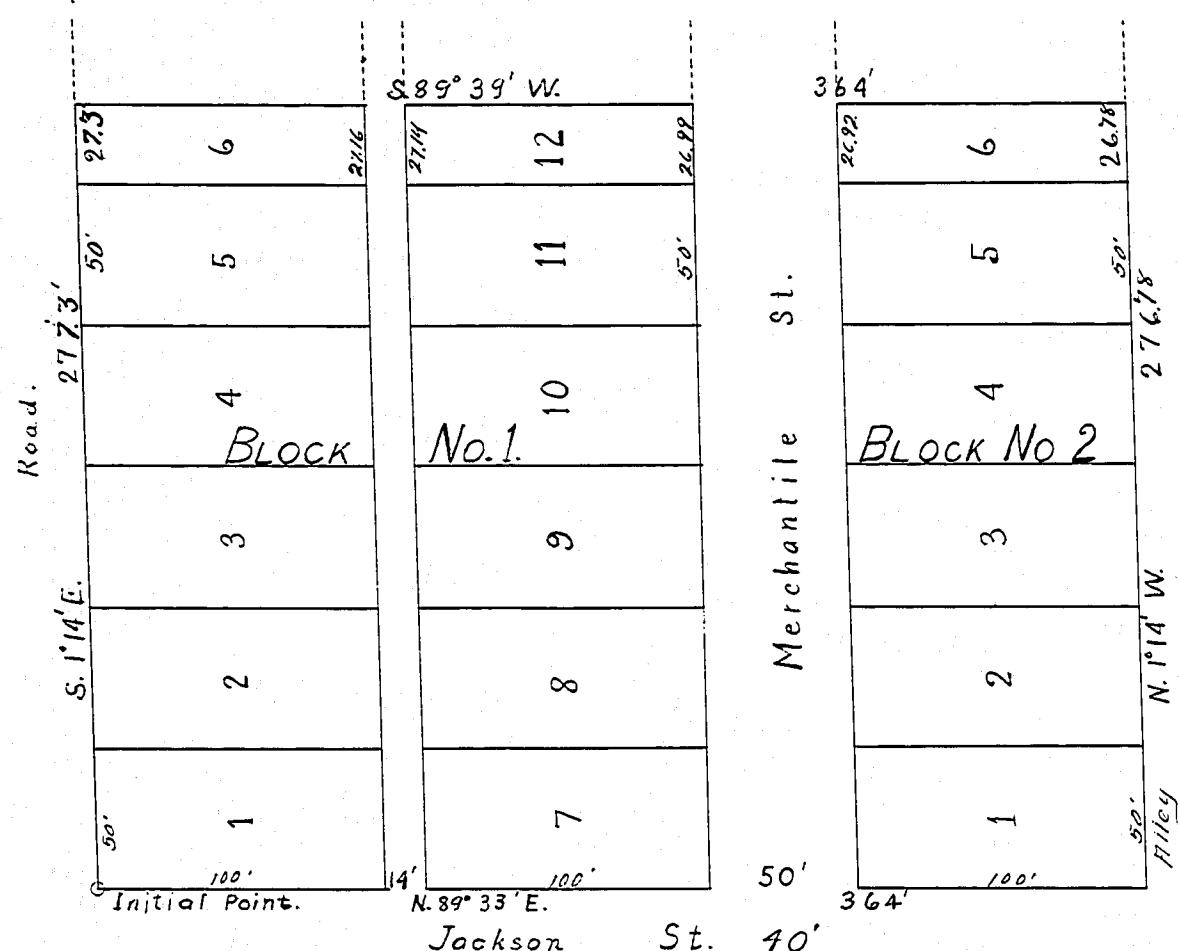

Know All Men By These Presents: that we, Marshall C. Miller and Anna L. Miller his wife, proprietors and owners of the lands described in the surveyors affidavit on the annexed plat of "Millers Second Addition to Corvallis," do hereby plat and lay out said tract of land into blocks, lots, and streets, and alleys as shown on said plat as a town plat to be known as "Millers Second Addition to Corvallis." said blocks are numbered 1 and 2, and blocks lots, alleys and streets are of size and dimensions as marked on the hereinto annexed plat. All dimensions are given in feet and we hereby dedicate said streets and alleys to the use of the public.

In Witness Whereof we have hereunto set our hands and seals this 1st day of November, 1911.
 On presence of
 Marshall C. Miller (SEAL)
 Anna L. Miller (SEAL)

State of Oregon } s.s.
 County of Benton }

This certifies, that on this 1st day of November, 1911, before me the undersigned, a Notary Public in and for said County and State, personally appeared the within named Marshall C. Miller and Anna L. Miller, his wife, who are each known to me to be the identical individuals described in and who executed the within instrument, and who acknowledged to me that they executed the same freely and voluntarily for the uses and purposes therein mentioned.

In Testimony Whereof I have hereunto set my hand and Notarial seal the day and year last above written.

Ernest J. Newton
 Notary Public for Oregon
 County Clerk for Benton County Oregon.

This Plat is hereby approved:

C. P. Beardall, C.E.
 City Engineer of the City of Corvallis

M. H. Rickard
 County Assessor

Victor C. Morse
 County Judge

A. W. Havelock
 Commissioner

Geo. W. Smith
 Commissioner

Ernest J. Newton
 1911

State of Oregon } s.s.
 County of Benton }

I, W. S. Galloway, being first duly sworn, say that I have correctly surveyed and marked with proper monuments the lands represented on this plat and that I planted a monument indicating the initial point of said survey as follows: Set a galvanized iron pipe 2 inches in diameter and three feet in length 6 inches below the surface of the ground, said point being N. 188° 36' E. and W. 123° 28' E. of the interior corner on the east line of the Charles Johnson D.T.S., member 52 Twp. 11 S. R. 5 W. of the W.M. in Benton County, Oregon.

Beginning at the said described initial point and running thence N. 89° 33' E. 364 ft. to a 3/4" pipe at the west side of the alley, thence N. 1° 14' W. along the said west line of alley 276.78 ft. to a 3/4" pipe, thence S. 89° 39' W. 364 ft. to a 3/4" pipe, thence S. 1° 14' E. 277.3 ft. to place of beginning.

That the property heretofore described and surveyed by me is situated within the corporate limits of the City of Corvallis.

Subscribed and sworn to before me this 1st day of Nov., 1911.

Ernest J. Newton
 Notary Public for Oregon
 County Clerk for Benton County, Oregon.

State of Oregon } s.s.
 County of Benton }

I, W. A. Sellatly Sheriff and Tax Collector of Benton Co., Oregon, do hereby certify that all back taxes on the within described property are paid.

Signed this 1st day of Nov. A. D. 1911.

W. A. Sellatly, Sheriff and Tax collector for Benton County, Oregon.

STATE OF OREGON } s.s.
 County of Benton }
 I hereby certify that the within instrument was received for record on the 16th day of November, 1911, at 11:45 A.M.
 and recorded in Book 3 of page 24 of said County.
 Witness my hand and seal of County Clerk.
 S. W. Warfield
 Recorder of County