

C 5 4023

T. 14 S., R. 7 W., W.M., Sec. 2
T. 13 S., R. 7 W., W.M., Sec. 35
BENTON COUNTY, OREGON



Survey-made for Bureau of Land Mgt.
to locate corners and mark boundaries
Surveyed-in Mar. 1967 with one minute
transit and 300' Tape by Robert Anderson
Bearings-based on needle observation
at S.E. corner of Sec. 35.

Scale 1" = 250'



Found: Snag 44" N36°W 21.6' to face
Scribing visible
Maple 16" S50°30'E 28.8' to face
Scribe visible on unhealed face

Scribed: Maple 17" N63°E 7.5' (1/4 S35 B.T.)
Fir 12" N01°E 28.0' (1/4 S35 BT)

Set: 3/4" x 36' Galv. I.P.

Found: 3/4" Pipe
Hemlock 20" S74°E 39Lks. Scribing visible
Roots of uprooted fir N22°W 5 Lks.
Clump of Vine maple N80°E 24Lks.
Scribed: Hemlock 35" N16°E 63 ft.
Fir 62" S12°30'E 77 ft.

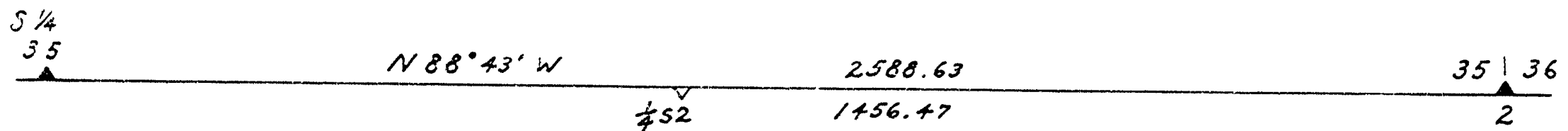

Set by: proportionate measurement
Scribed: Fir 44" S64°E, 67.0' (1/4 S 2 BT)
Set: 3/4" x 36" Galv. I.P.