



RECORD OF SURVEY FOR BENTON COUNTY

LYING IN THE SE 1/4 OF SECTION 36,
T.10 S., R.4 W., W.M. AND THE GALLATIN
ADKINS DONATION LAND CLAIM No. 43

Benton County
Surveyor's Office

C. S. FILE NO. 7915
FILING DATE 8-20-86
PLOT SIZE 8 1/2 x 14

LEGEND
● MONUMENT FOUND
○ MONUMENT RESET
() RECORD INFORMATION

DATE: JULY 31, 1986
SCALE: 1" = 50'

PREPARED BY:
BENTON COUNTY PUBLIC WORKS
360 S.W. AVERY AVE.
CORVALLIS, OR. 97333

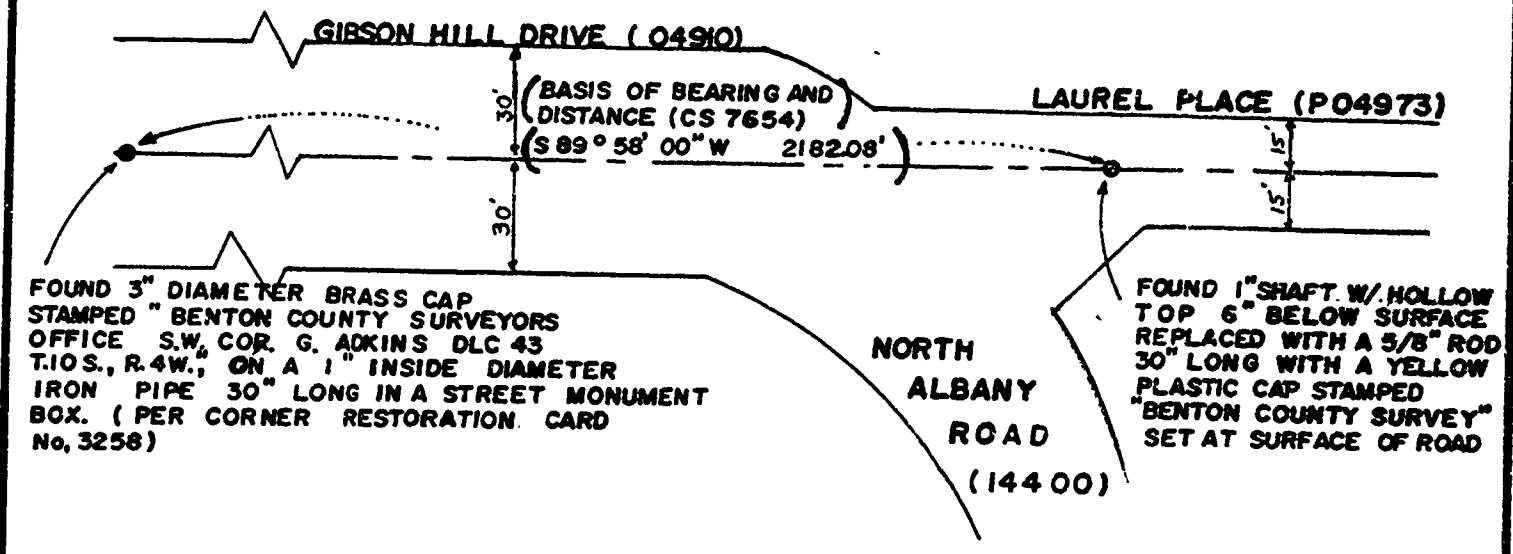

NARRATIVE

1. THE PURPOSE OF THIS SURVEY WAS TO REPLACE THE 1" SHAFT WITH A 5/8" ROD AFTER CONSTRUCTION OF A WATERLINE DURING JULY 1986.
2. THE 1" SHAFT WAS REFERENCED BEFORE CONSTRUCTION. DURING CONSTRUCTION THE 1" SHAFT WAS REMOVED. AFTER CONSTRUCTION A 5/8" ROD WITH A YELLOW PLASTIC CAP STAMPED "BENTON COUNTY SURVEY" WAS SET FROM THE REFERENCE POINTS.
3. THE SHAFT THAT WAS REPLACED IS THE PI. OF A CURVE AT THE INTERSECTION OF GIBSON HILL DRIVE (04910) AND NORTH ALBANY ROAD (14400). PIPE IS LOCATED IN THE CENTERLINE OF LAUREL PLACE (P04973).
4. ON SHEET 14 OF THE 1923 ORIGINAL NOTES AND THE ORIGINAL ROAD PLANS BY GALLOWAY (NORTH ALBANY ROAD / MARKET ROAD, ROUTE 40 SECTION A, ROAD NUMBER 14400 AT THE BENTON COUNTY PUBLIC WORKS OFFICE) A 1" SHAFT WITH A HOLLOW TOP IS CALLED OUT. THIS WAS LATER REFERENCED ON SEVERAL MAPS AS A 1" PIPE.

REGISTERED
PROFESSIONAL
LAND SURVEYOR
Danna E. Ingram
OREGON
JULY 16, 1982
DANNA E. INGRAM
1982